

HPNLS-MIX

Small Profile Color Changing LED Fixture



Customer: _____ Date: _____
Project: _____

Wattage	14W per linear ft*
Input Voltage	90-120V, 230-277V
Control	Standard DMX 512
LED Spacing	1.0" on Center
Length	12"-96", in 12" increments
Total Height	1.68"
Total Width	1.80" (not including clip)
Color Options	Alternating RGB, RGBW, Triple Diode RGB, White Mixing
Mounting	Fixed, Hinge, Vandal, Arc 3 or Arc 6
Available Optics	10°, 30°, 60°, 10°x30°, 10°x60°, 30°x60°, 120°
Rating	IP50, IP67, IP69K
CRI	90+ for White Mix Only
Power Cable	UL Standard 10 ft
Environmental	Operating temperature: -40°F-140°F Ambient(-40°C-60°C)** Storage temperature: -40°F-140°F Ambient indoor fixtures operation limited to =<50% relative humidity

*Custom wattage available upon request. Title 24 compliant fixture not to exceed 18 watts / 4ft fixture.

** Military spec available under special request-lead times may be impacted.



PRODUCT SPECIFICATIONS:

	COLOR OPTION	OPTIC	VOLTAGE	FINISH	LOCATION	MOUNTING	LENS	WHITE MIXING OPTIONS
HPNLS-MIX								
	RGB	10°	120V	W White	I Interior-IP50	F Fixed	C Clear	If specifying WM indicate white options here: (Up to 3 different options can be specified) 2700K 3000K 3500K 4000K 5000K Amber
	RGBW	30°	277V	B Black	E Exterior-IP67	H Hinge	D Diffused	
	TRGB Triple Diode (120° only)	60°		G Gray	K IP69K-Extreme Enviroment	3Arc 3" Arc Swivel	SI Satin Ice (Interior Use Only)	
	WM White Color Mixing	10°x30°				6Arc 6" Arc Swivel	OP Opal White	
	*See White Mix Options	30°x60°				V Vandal Resistant		
		120°						
OPTIONS								
SB Square Baffle		HL Hexcell Louver						
ASYM Asymmetric Baffle		(Cannot be used with Satin						
SKB Kicker Baffle		Ice White or 120° optic)						

DIMENSIONS:

For vertical installation and installations above 4' please contact the factory for specific mounting instructions.

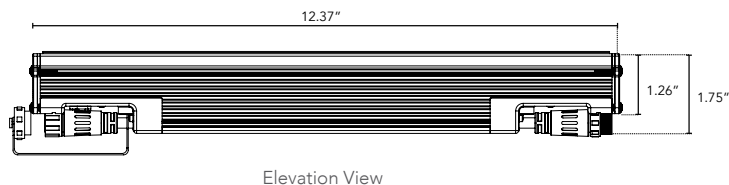
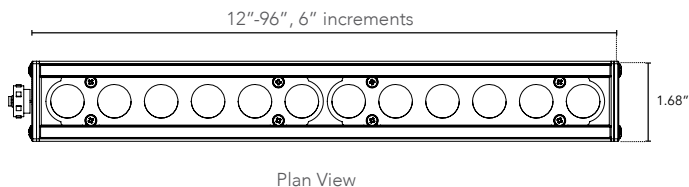

MOUNTING INFORMATION:

Note: Fixtures 1-2ft, Place clips 3" from edge as shown. Fixtures more than 2ft., Place clips 3.5" from edges as shown.

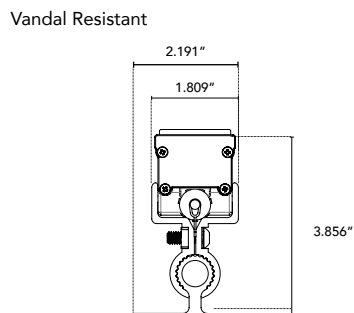
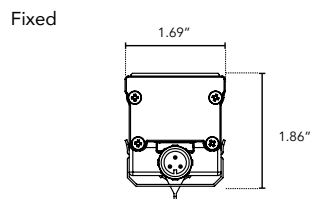
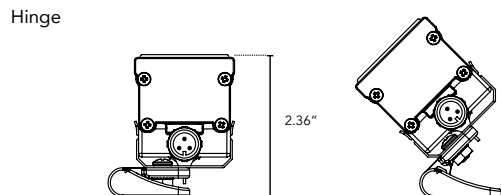
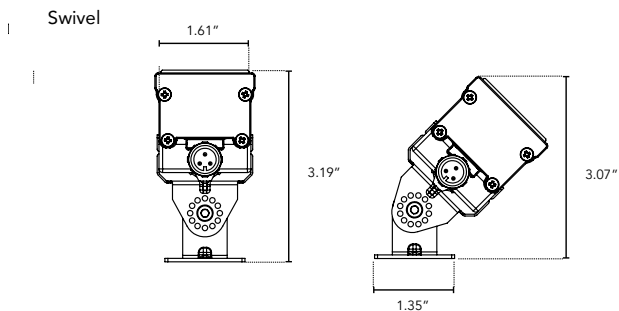

LIGHTSOURCE REPORT

WHITE W/CLEAR GLASS LENS

- CIE Colorimetric Parameters
- CCT: Tc = 3088K
- Photometric Parameters
- Luminous Flux: 634.40 lm
- Efficiency: 59.46 lm/W

WHITE W/CLEAR GLASS LENS

- RGBW w/Clear Glass Lens
- CCT: Tc = 4392K
- Photometric Parameters
- Luminous Flux: 922.16 lm
- Efficiency: 34.65 lm/W